

Boiler, fill and drain valves for heating systems.

Housing and ball

Rotating handle

Ball and cutting ring seal

Stem seal and cap

Medium and ambient temperature

Operating pressure

KFE-12: Brass
 KFE-12N: Nickel-plated brass
 Zinc-diecast
 PTFE
 EPDM
 max. +110 °C
 max. 10 bar

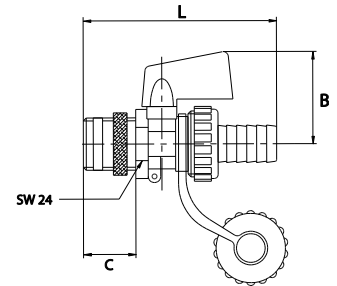

KFE ball valve

Art. No.	Ident No.	Thread	Stem	B mm	C mm	L mm
KFE-12	103414	G 1/2	LW 13	37.0	20.0	74.6
KFE-12N	103415	G 1/2	LW 13	37.0	20.0	74.6

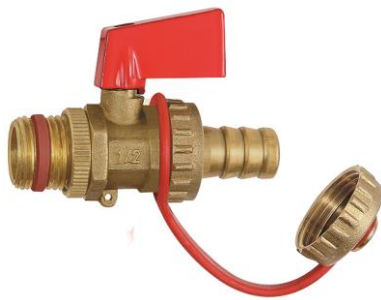

KFE-12



KFE-12N